



Tata Steel International (Australasia) Ltd

---

# Flanges

---

Stainless Steel



**TATA STEEL**

# SECTION E

## Contents

---

Galvanised Back-up flanges / Neck rings	Page	E1
---	------	----

---

Stainless Steel Flanges	Page	E2
-------------------------	------	----

---

---

---

---

---

---

---

---

---

---

# GALVANISED BACK-UP FLANGES / NECK RINGS

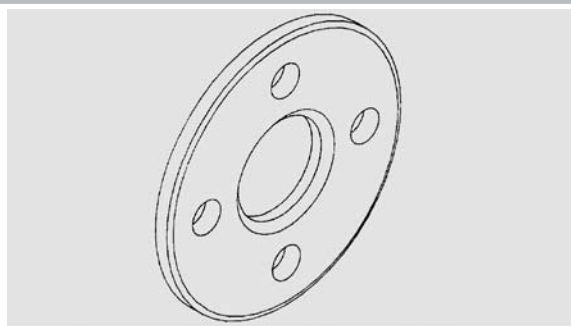

Back-Up Flanges and Neck Rings held in stock to suit Tube and Spiral Welded Pipe. Schedule Pipe dimensions may also be available. Marine department certification is available.

Nominal Diameter	Flange O.D. (mm)	Flange Thickness (mm)		No. of Bolt Holes (mm)		Bolt Hole Diameter		Pitch Circle Diameter – PCD (mm)
		Table D	Table E	Table D	Table E	Table D	Table E	
¾" 20mm	100	5	6	4	4	14	14	73
1" 25mm	115	5	8	4	4	14	14	83
1 ¼" 32mm	120	6	8	4	4	14	14	87
1 ½" 40mm	135	6	10	4	4	14	14	98
2" 50mm	150	8	10	4	4	18	18	114
2 ½" 65mm	165	8	10	4	4	18	18	127
3" 80mm	185	10	12	4	4	18	18	146
4" 100mm	215	10	12	4	8	18	18	178
5" 125mm	255	12	16	8	8	18	18	210
6" 150mm	280	12	16	8	8	18	22	235
8" 200mm	335	12	20	8	8	18	22	292
10" 250mm	405	16	20	8	12	22	22	356
12" 300mm	455	20	25	12	12	22	26	406
14" 350mm	525	25	32	12	12	26	26	470

Back-Up Flanges to other standards, and dimensions may be available on request.

## Neck Rings (Pressed) – T316L Stainless Steel

Nominal Diameter	E (mm)	T (mm)	L (mm)
¾" 20mm	56	1.50	7
1" 25mm	66	1.50	8
1 ¼" 32mm	75	1.50	9
1 ½" 40mm	83	1.50	12
2" 50mm	95	1.50	12
2 ½" 65mm	108	1.50	12
3" 80mm	127	1.50	12
4" 100mm	158	1.50	20
5" 125mm	184	1.50	20
6" 150mm	212	1.50	20
8" 200mm	270	3.00	20
10" 250mm	330	3.00	20
12" 300mm	381	3.00	20
14" 350mm	441	3.00	25

These Neck Rings can also be used with Table E and ASA 150 Back-Up Flanges. Neck Rings in other grades, standards, and dimensions may be available on request

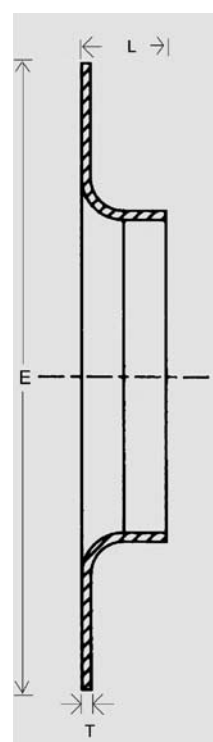

# STAINLESS STEEL FLANGES

**Table E Flanges** – manufactured from T316 Stainless Steel are available in the following configurations:

- **Flat Face Slip On** to suit hygienic tubes 1" – 6"
- **Flat Face Slip On** to suit schedule pipes 1/2" – 12"
- **Flat Face Blind** to suit schedule pipes 1/2" – 12"

Nominal Diameter	Flange O.D. (mm)	Flange Thickness (mm)	No. of Bolt Holes	Bolt Hole Diam (mm)	Pitch Circle Diameter – PCD (mm)
½" 15mm	95	6	4	14	67
¾" 20mm	100	6	4	14	73
1" 25mm	115	7	4	14	83
1 ¼" 32mm	120	8	4	14	87
1 ½" 40mm	135	9	4	14	98
2" 50mm	150	10	4	18	114
2 ½" 65mm	165	10	4	18	127
3" 80mm	185	11	4	18	146
4" 100mm	215	13	8	18	178
5" 125mm	255	14	8	18	210
6" 150mm	280	17	8	22	235
8" 200mm	335	19	8	22	292
10" 250mm	405	22	12	22	356
12" 300mm	455	25	12	26	406

**ANSI 150 Flanges** – manufactured to ASTM A182 from T316 Stainless Steel are available in the following configurations:

- **Raised Face Slip On** to suit schedule pipes 1/2" – 12"
- **Raised Face Blind** to suit schedule pipes 1/2" – 12"

Nominal Diameter	Flange O.D. (mm)	Flange Thickness (mm)	Overall Height for RFSO (mm)	No. of Bolt Holes	Bolt Hole Diam (mm)	Pitch Circle Diameter – PCD (mm)
½" 15mm	88.9	11.2	15.7	4	15.7	60.5
¾" 20mm	98.6	12.7	15.7	4	15.7	69.9
1" 25mm	108.0	14.2	17.5	4	15.7	79.2
1 ¼" 32mm	117.3	15.7	20.6	4	15.7	88.9
1 ½" 40mm	127.0	17.5	22.4	4	15.7	98.6
2" 50mm	152.4	19.1	25.4	4	19.1	120.7
2 ½" 65mm	177.8	22.4	28.4	4	19.1	139.7
3" 80mm	190.5	23.9	30.2	4	19.1	152.4
4" 100mm	228.6	23.9	33.3	8	19.1	190.5
5" 125mm	254.0	23.9	36.6	8	22.4	215.9
6" 150mm	279.4	25.4	39.6	8	22.4	241.3
8" 200mm	342.9	28.4	44.5	8	22.4	298.5
10" 250mm	406.4	30.2	49.3	12	25.4	362.0
12" 300mm	482.6	31.8	55.6	12	25.4	431.8

Flanges in other grades, standards, and dimensions may be available on request.



## Tata Steel International (Australasia) Ltd

---

<b>Head Office</b>	7 Bruce Roderick Drive East Tamaki Phone 09 271 1780	PO Box 58880, Botany, Manukau 2163 Fax 09 271 1970 Email: headoffice@tatasteelnz.com
<b>Auckland</b>	7 Bruce Roderick Drive East Tamaki Phone 09 271 1781	PO Box 58880, Botany, Manukau 2163 Fax 09 271 1799 Email: auckland@tatasteelnz.com
<b>Mt Maunganui</b>	18 MacDonald Street Phone 07 574 0095	PO Box 4158, Mt Maunganui South 3149 Fax 07 574 0096 Email: tauranga@tatasteelnz.com
<b>Hamilton</b>	27 Ellis Street, Frankton Phone 07 847 8456	PO Box 1133, Waikato Mail Centre 3240 Fax 07 847 0354 Email: hamilton@tatasteelnz.com
<b>Hastings</b>	807 Warren Street Phone 06 876 3360	PO Box 14043, Mayfair, Hastings 4159 Fax 06 876 3411 Email: hastings@tatasteelnz.com
<b>New Plymouth</b>	Cnr Connett Road & Mustang Drive, Bell Block Phone 06 759 9382	PO Box 3094, Fitzroy New Plymouth 4341 Fax 06 755 7575 Email: newplymouth@tatasteelnz.com
<b>Wellington</b>	141 Hutt Park Road Phone 04 568 5014	PO Box 38065, Lower Hutt 5045 Fax 04 568 6367 Email: wellington@tatasteelnz.com
<b>Nelson</b>	4C Akersten Street Phone 03 548 0603	PO Box 413, Nelson 7040 Fax 03 548 0588 Email: nelson@tatasteelnz.com
<b>Christchurch</b>	200 Maces Road, Bromley Phone 03 381 1994	P O Box 570, Christchurch Mail Centre 8140 Fax 03 381 0606 Email: christchurch@tatasteelnz.com

---

**Toll free: 0800 4 26787**

**Website: [www.tatasteelnz.com](http://www.tatasteelnz.com)**

Care has been taken to ensure that the contents of this publication are accurate but Tata Steel International do not accept responsibility for errors or for information which is found to be misleading. Suggestions for or descriptions of the end-use or application of products or methods of working are for information only and the company accepts no liability in respect thereof. Before using products supplied or manufactured by the company the customer should satisfy themselves of their suitability. If further assistance is required the company which has extensive research facilities will often be able to help.